

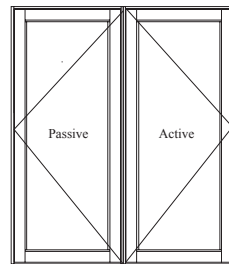

SI2200 thermally-broken aluminum terrace door for use in commercial and residential applications. Side hinged, in-swing and out-swing, single or French door configurations with multi-point terrace door hardware. Durable construction features mitered corners, and both residential and commercial hardware.

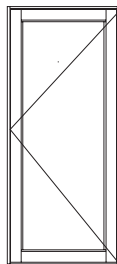

## Features:

- 2 13/16" frame depth
- Thermally-broken aluminum profiles and sill
- Single or French doors
- Inswing or outswing
- Insulated and monolithic glazing infills from 3/16" to 1 1/8"
- Standard hardware options
- Multi-point locking hardware for added security
- Aluminum semi-concealed hinge extrusions with stainless steel hinge pins, manufactured by Solar Innovations, Inc.
- Standard finishes: AAMA 2603
  - Duracron: Hartford Green, Bronze, Black, Natural Clay, White, Sandstone
- Class I Anodized: Dark Bronze, Clear
- Maximum size dependent upon engineering requirements

## Options:

- ADA compliant sill options
- Operable or fixed matching sidelites and transoms
- Variety of handle set styles and finishes
- Concealed hold open
- Custom finishes
  - Powder coat finish: AAMA 2604-05
  - Fluoropolymer (50% or 70%): AAMA 2604-2605
  - Veneer & cladding options
- SDLs, and decorative interior and exterior grids
- Custom mullion heights available
- Designed to accommodate any monolithic, insulated, laminated, decorative, polycarbonate, or solid panel infill



### Head Detail SI2200

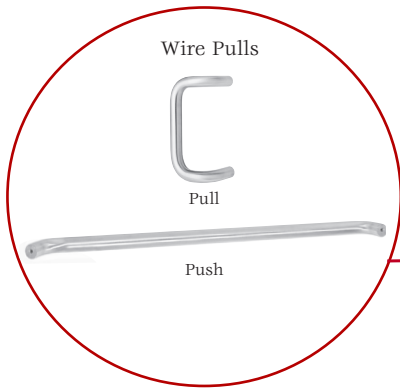
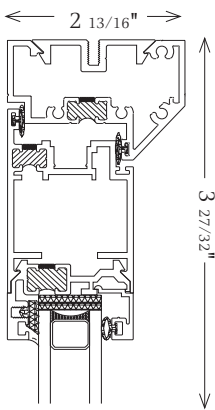

### Sill Options SI2200

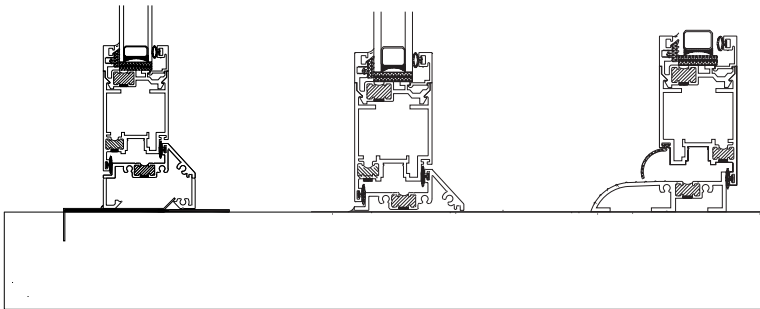

### Hinge Options



Coverplate color choices:  
 Clear Anodized  
 Dark Bronze Anodized  
 Black  
 Bronze  
 Natural Clay  
 White  
 Sandstone  
 Hartford Green

Semi-concealed Hinge, Hinge Barrel, End Cap, and Wire Pull Hinge Handle color choices:  
 Clear Anodized  
 Dark Bronze Anodized

### Exterior Entry Trim



Matching interior passage sets available. For double door applications, concealed vertical rod panic hardware is available. Entry trim with thumb turn and wire pull available.

### Inland Applications

#### Back Plate Options



Both styles available with:

- 46 - Thumb Turn - Interior Lever - Exterior
- 10 - Lever - Interior Lever - Exterior
- 92 - Thumb Turn - Interior Keyed Exterior

#### Solid Brass Handle Options

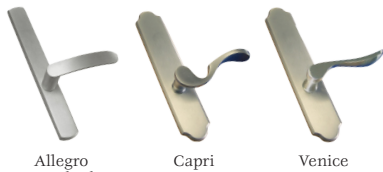

Not available for doors exceeding 2 1/2" thickness

#### Color Options



#### Aluminum Options

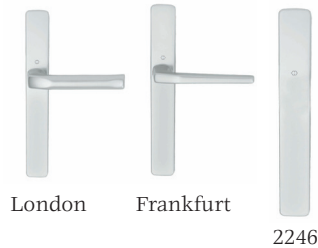

#### Color Options



### Coastal Applications

#### Back Plate Options

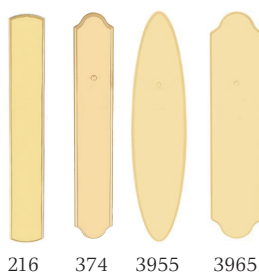

#### Brass Handle Options

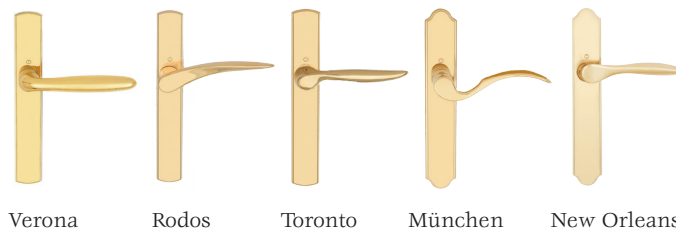

#### Color Options

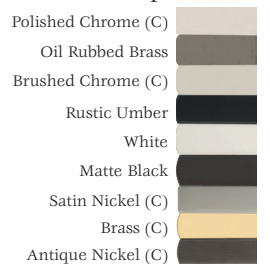

(C) = Heavy Saltwater Resistant Finishes

Performance Test#110-9445-2				
Panel Size	Swing	DP (psf)	Air (@ 1.57psf)	Water (@ 5.0gph/ft <sup>2</sup> )
40" x 96"	Out	± 45	.02	6.75
110-95191R-S	U Factor = .55		CRF = 49	

Testing and performance results may vary depending upon sill and hardware selections. Please be sure to visit our website for additional product information.

[www.solarinnovations.com](http://www.solarinnovations.com)

