

SI7251 • SI7252 • SI7253 • SI7254

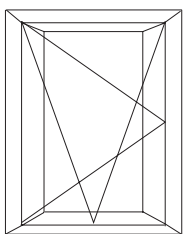

SI7250 Thermally enhanced aluminum window system for use in commercial and high-end residential applications. The “European-style” profiles are designed with an “Ameri-groove” for integrating completely concealed multi-point locking hardware. Mitered corners provide exceptional strength to the sash and outer frame.



SI7251
Tilt Turn

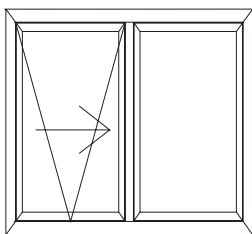

SI7252
Tilt Slide

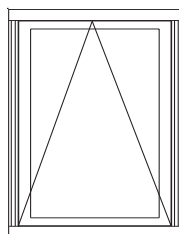

SI7253
Awning

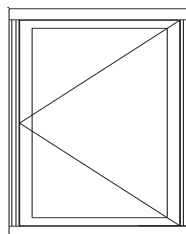

SI7253
Casement

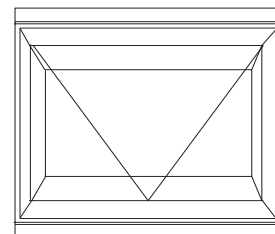

SI7253
Hopper

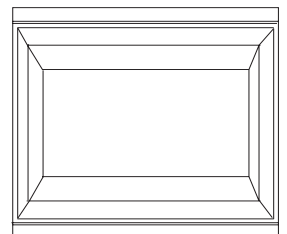

SI7254
Fixed

Features:

- Thermally enhanced with iso-bars
- Operations (Inswing)
 - SI7251 Tilt Turn
 - SI7252 Tilt Slide
 - SI7253 Casement, Awning, Hopper
 - SI7254 Fixed
- Glazing infills up to 1 1/8"
- Multi-point locking hardware
- Standard Finishes
 - Duracron: Hartford Green, Bronze, Black, Natural Clay, White, Sandstone

Options:

- Decorative Grids
- Hardware options (cam lock, crank out handle)
 - Keyed lock
 - Heavy saltwater resistant finishes
- Oversized panels upon request
- Custom finishes
 - Class I anodized: Dark Bronze, Clear
 - Powder coat finish: AAMA 2604-05
 - Fluoropolymer: 50% or 70%
 - Wood and metal cladding
- Mesh insect screen available
- Integrated side lites and transoms



SI7250

European System

SI7251 • SI7252 • SI7253 • SI7254

Narrow Style SI7251 & SI7253

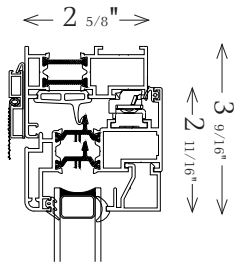

Standard Style SI7251 & SI7253

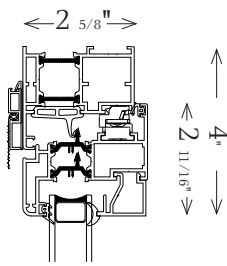

Detail SI7254

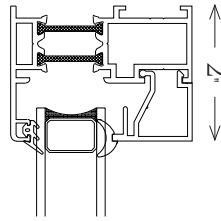

Mulling Profile

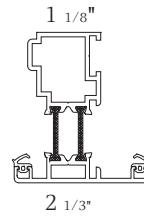

Detail SI7252

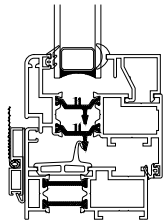
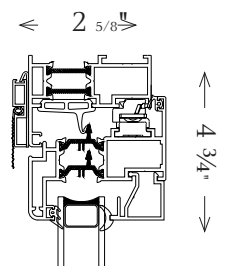

SI7251 Tilt Turn

- Minimum Size 23" x 31"
- Maximum Size 66" x 108"

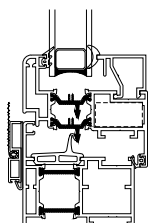

SI7253 Casement, Awning, Hopper

- Minimum Size 23" x 31"
- Maximum Size 66" x 108"

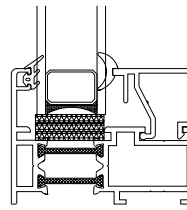

SI7254 Fixed

- Maximum Size 60" x 120"

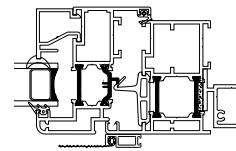

In System Flange Profile

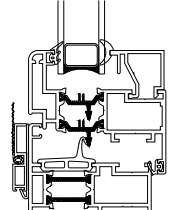

SI7252 Tilt Slide

- Minimum Size 34" x 40"
- Maximum Size 60" x 108"



Mannon Window
Tilt Turn Window



Prima
Tilt Turn Doors/Windows
In-swing Euro Casement Windows
In-swing Euro Awning Windows
In-Swing Euro Hopper



Unica
Out-swing Euro Casement Windows
Out-swing Euro Awning Windows
Hopper Windows
Tilt Turn Windows

Stock Handle Options

Available in Satin Chrome and Satin Bronze only.



Tilt Turn Windows
In-swing Euro Casement
** Additional charges apply.
Current inventory may extend lead times.

EvoDesign Custom Handle Options***



*** Additional charges apply - 10-12 week lead time applies, current inventory may extend lead times.

Performance Test # 110-12031-1S					
Series	Panel Size	Rating	DP (psf)	Air (@ 1.57psf)	Water (@ 5.0gph/ft ²)
SI7251	60" x 99"	DAW-HC40	± 40	.10	6.0

Testing and performance results may vary depending upon sill and hardware selections.
Please be sure to visit our web site for additional product information.

www.solarinnovations.com

