

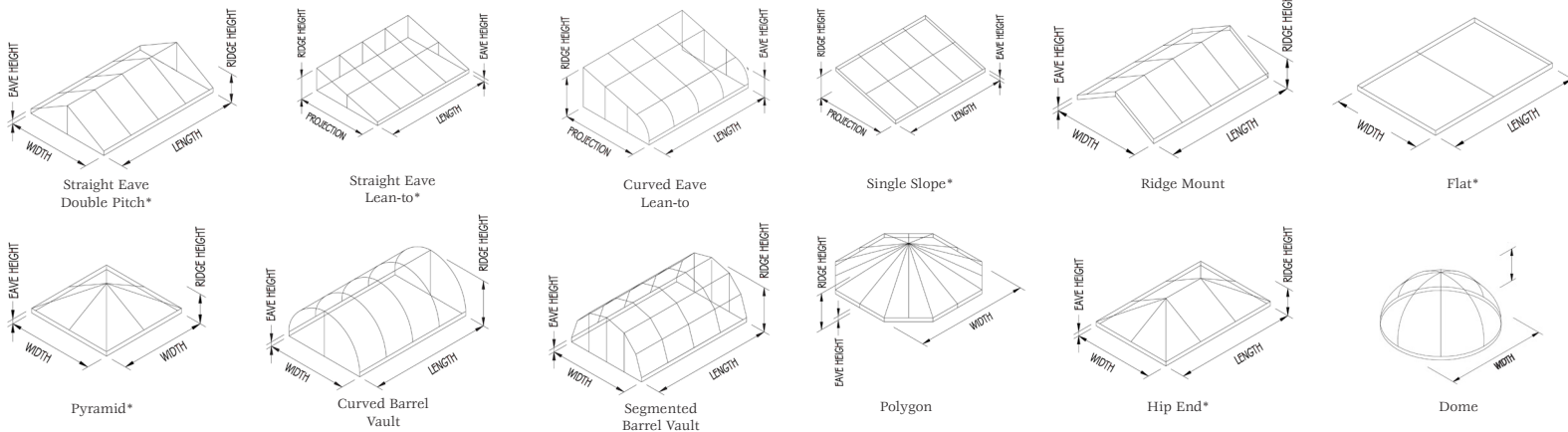

SI5006 “stick built” skylight system for commercial and residential applications. Any size or configuration is possible, using aluminum or wood rafters and purlins. Solar Innovations, Inc offers standard options, as well as any custom configuration and layout you can imagine. Shipping/product delivery can be modular, pre-assembled and/or pre-glazed, or knocked down depending upon job site requirements.



Features:

- Thermally-broken aluminum skylight profiles
- System designed to attach in any condition
- 2-or 3-Tiered drainage system with concealed interior condensation gutters
- Glazing infills from 3/16" to 1 1/2"; thicker glass options depending upon engineering
- Standard finishes
 - Duracron: Hartford Green, Bronze, Black, Natural Clay, White, Sandstone
- Minimum pitch: contact Solar Innovations®

Options:

- Aluminum or wood rafters and purlins
- Custom finishes
 - Class I anodized: Dark Bronze, Clear
 - Powder coat finish: AAMA 2604-05
 - Fluoropolymer: 50% or 70%
 - Wood and metal cladding
- Operable and retractable venting options
- Largest selection of decorative accessories available
- Designed to accommodate any monolithic, insulated, laminated, decorative, polycarbonate, or solid panel infill.
- High efficiency Nanogel infill available



SI5006

Stick Built Skylights

SI5206 • SI5256 • SI5306



End Wall Bar
SI5200

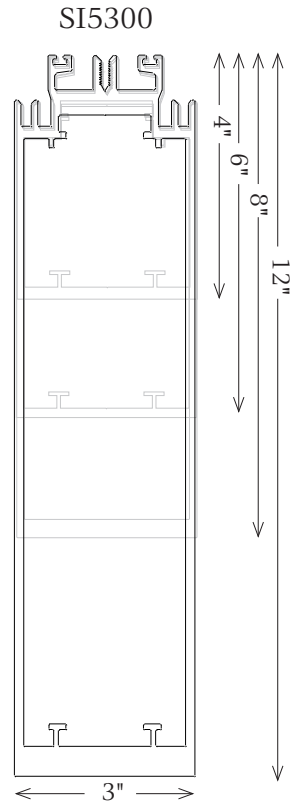
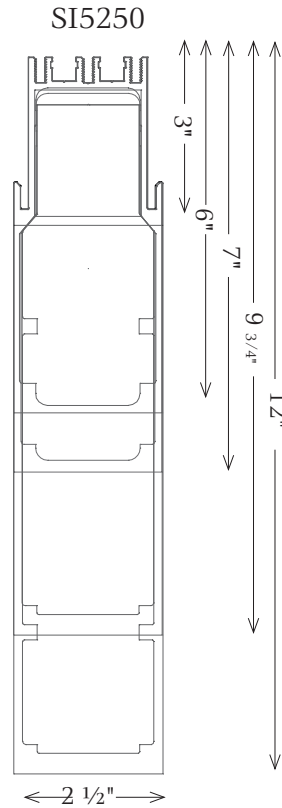
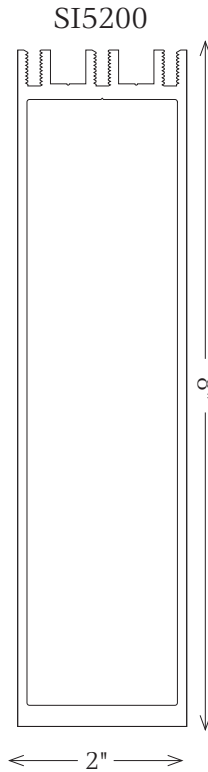
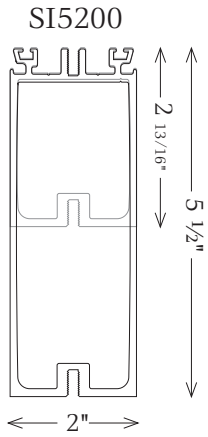
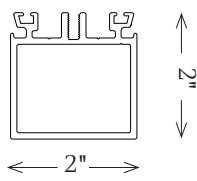

Standard Muntin
2"

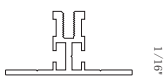

2-Tier Muntin
2"

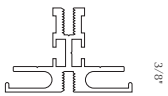

Beveled Muntin
2"

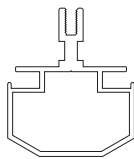

Boxed Muntin
2"

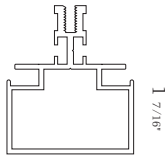

End Wall Bar
2"

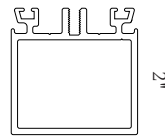

2 1/4" Horizontal Purlin
3"

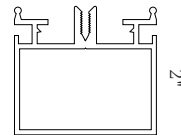

Horizontal Purlin
3"

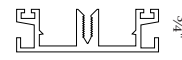

SSG Horizontal Purlin
3"

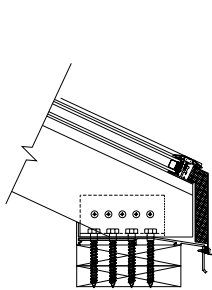
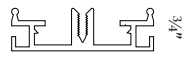

Extruded Curb

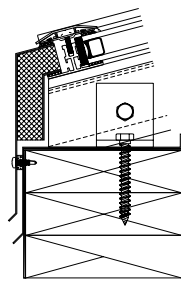

Regular Clip Sill

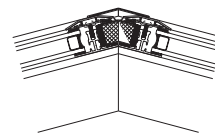

Double Pitch Ridge

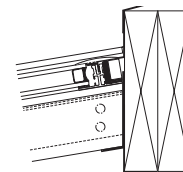

Lean-to Ridge

Performance Test#110-11306-2 - 5300 Series			
Maximum Glass Size	DP (psf)	Air (@ 6.24psf)	Water (@ 6.24psf)
45 1/4" x 61 1/4"	± 65	.01	12.0

* Tested System **2.5" and 3" FGS are possible
Testing and performance results may vary depending upon sill and hardware selections.
Please be sure to visit our website for additional product information.

www.solarinnovations.com

