

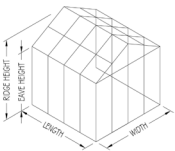

SI5000R series is a modern, thermally enhanced glazing system intended to replicate the delicate structures of the past. The glazing bars have a historic shape when compared to a flat faced modern bar. The glazing is insulated and tempered compared to single pane and only annealed. Wheels can be created to turn the ventilation as in older greenhouses in replacement of modern electric motors.

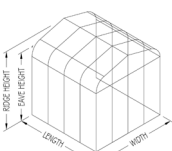

Straight Eave  
Double Pitch



Curved Eave  
Double Pitch

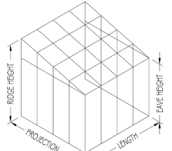

Straight Eave  
Lean to

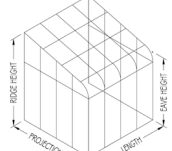

Curved Eave  
Lean to

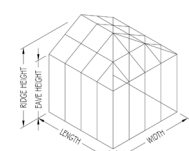

Hip End

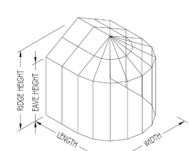

8 Sided  
Conservatory

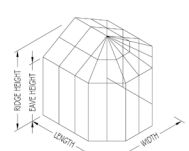

Conservatory  
Nose

### Features:

- Thermally enhanced aluminum profiles and sill members
- Overlapping construction creates positive drainage within profiles
- Glazing infills from 3/16" to 1 1/8"; thicker glass options dependent upon engineering
- Standard finishes
  - Duracron: Hartford Green, Bronze, Black, Natural Clay, White, Sandstone
- Seamlessly integrate Solar Innovations, Inc. operable door and window systems
- Integrated slope glazing with operable vents
- LEED friendly system including recycled content
- Designed and manufactured in the U.S.A.

### Options:

- Decorative accessories
  - Cover caps, interior trim (crown, sill, etc), column covers, gutters, finials, SDL's, and ring and collar
- Custom aluminum finishes
  - Class I anodized: Dark Bronze, Clear
  - Powder coat finish: AAMA 2604-05
  - Fluoropolymers: 50% or 70%
  - Wood and metal cladding
- Free-standing structures; or integrated steel structures
- Photo-voltaic panel inserts (BIPV)
- Turn-key solutions for greenhouses, pool enclosures, and sunrooms

Additional configurations available.



# SI5000R

# Restoration System

## SI5200R

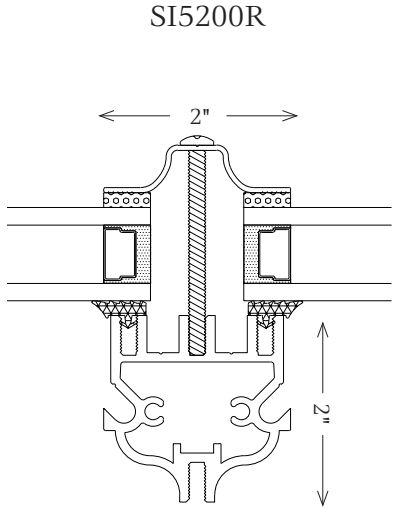

2 Tier Muntin

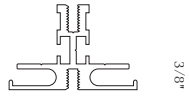
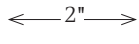

1/4" 2 Tier Muntin

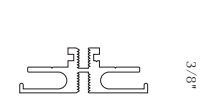
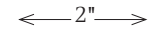

Regular Sill

4 5/8"

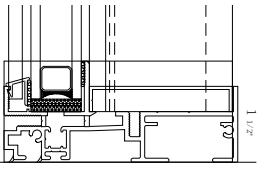

Heavy Sill

7 5/16"

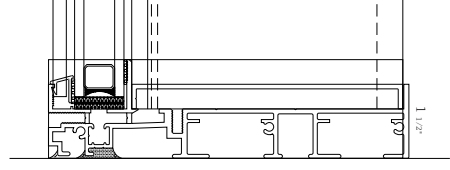

Please be sure to visit our website for additional product information.  
[www.solarinnovations.com](http://www.solarinnovations.com)

