

Stacking Glass Wall System

SI3000S

SI3250S • SI3350S • SI3450S • SI3600S



Series SI3000S top hung thermally enhanced aluminum stacking glass wall panel system for use in commercial and residential applications. Exceptional air, water, structural, and thermal performance with multiple sill options and profile dimensions provide greater performance and design flexibility. Customization of product profiles, hardware, sills, and testing can be completed.

60° Offset Individual Panels
Stacking wall configurations in excess of 8' ft. in height should utilize the 60° configurations for ease of one handed door operation.

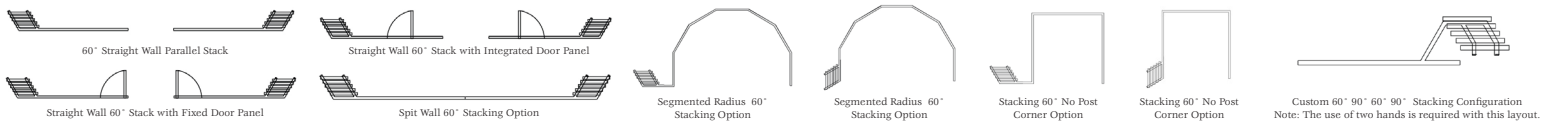

90° Offset Individual Panels

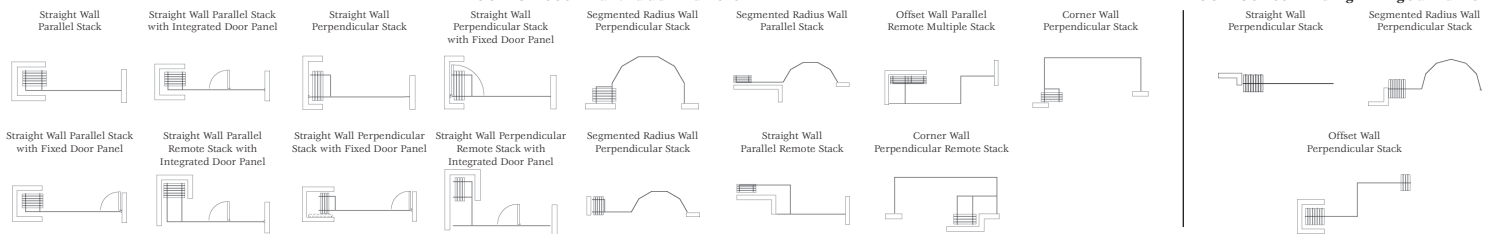

Limitless custom configurations are available, consults Solar Innovations, Inc. sales and engineering departments for project specific designs.

Features:

- Outstanding water performance, up to 6.0 psf
- Thermally enhanced profiles with iso-bar
- Operable hardware custom manufactured by Solar Innovations, Inc.
- Custom stainless steel helical bearings rated for a maximum capacity of 350lbs./pair
- Larger panels accommodated with multiple bearings
- Multiple hardware styles and finishes available
- Accommodates monolithic and insulated glazing infills from 3/16" to 1 1/8"
- Standard finishes: AAMA 2603
 - Duracron: Hartford Green, Bronze, Black, Natural Clay, White, Sandstone
- Class I anodized: Dark Bronze, Clear
- LEED friendly system including recycled content
- Designed and Manufactured in the U.S.A.

Options:

- Matching fixed transoms and sidelites
- Integrated swing doors: single or double
- Custom finishes
 - Powder coat finish: AAMA 2603-2604
 - Fluoropolymer (50% or 70%): AAMA 2604-2605
 - Veneer & cladding options
 - Dual color or dual finishes options
- Decorative interior and exterior grids
- Screen options: folding, sliding, retractable
- Multiple sill designs, including ADA compliant ramps
- Factory installed sill drain tubes when required
- Designed to accommodate any monolithic, insulated, laminated, decorative, polycarbonate, or solid panel infill



SI3000S

Stacking Glass Wall System

SI3250S • SI3350S • SI3450S • SI3600S

Last Revised on: 5/15/2013

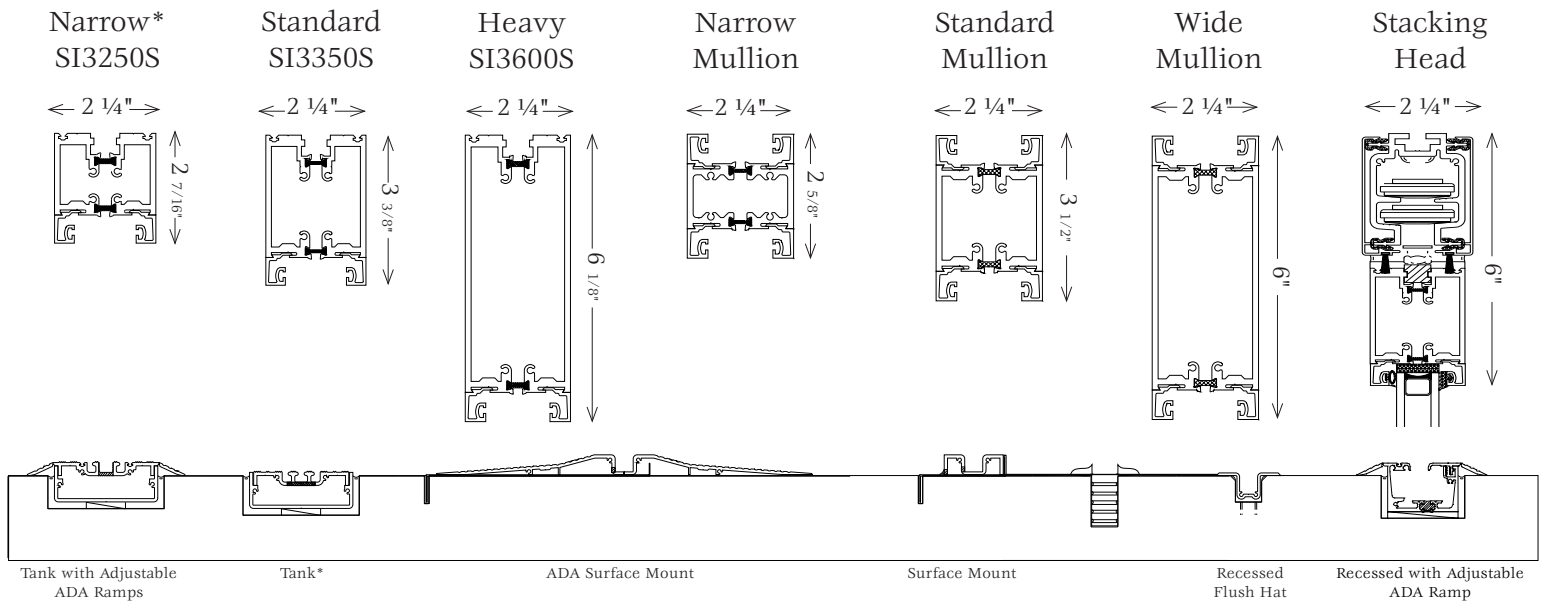

Coastal Applications

Back Plate Options



Brass Handle Options

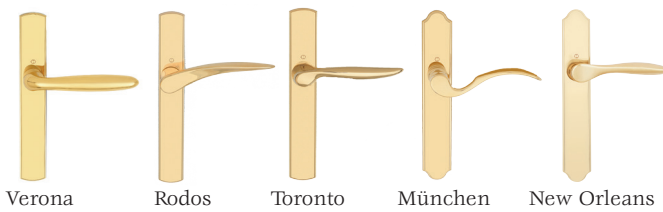

Color Options

- Polished Chrome (C)
 - Oil Rubbed Brass (C)
 - Brushed Chrome (C)
 - Rustic Umber (C)
 - White (C)
 - Matte Black (C)
 - Satin Nickel (C)
 - Brass (C)
 - Antique Nickel (C)
- (C) = Heavy Saltwater Resistant Finishes

*Product Option Not Yet Tested. Oversized units are available dependent upon engineering approval.

Exterior Entry Trim



Inland Applications

Back Plate Options



Both styles available with:

- Thumb Turn - Interior
- Lever - Exterior
- Lever - Interior
- Lever - Exterior
- Thumb Turn - Interior
- Keyed Exterior

Solid Brass Handle Options

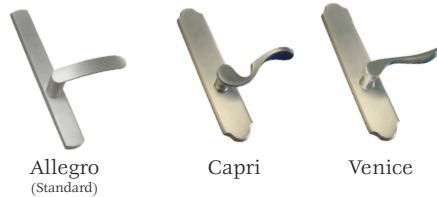

Color Options

- Satin Chrome
- Polished Chrome
- Polished Brass
- Antique Brass
- Dark Bronze (25 US10B)
- Pewter
- White
- Black

Hardware not available for doors exceeding 2 1/2" thickness

Inland Applications Aluminum Options

Back Plate Handle Options

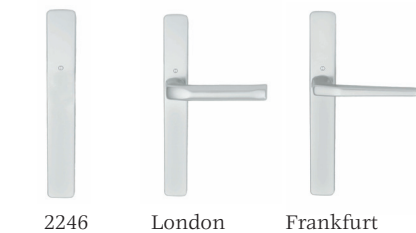

Color Options

- Pure White
- Chesnut
- Painted Silver

Wire Pulls



Testing Performance						
Panel Size	Sill Option	Test #	Air@ (1.57psf)	Water (psf)	Structural DP	U-Factor
34" x 90"	Tank Sill*	110-12624-1	0.25	6.0	± 40	n/a

Oversized units are available dependent upon engineering approval.

*Using SI3250 vertical rails requires 3350 top and bottom rails.

Testing and performance results may vary depending upon sill and hardware selections.

Please be sure to visit our web site for additional product information.

www.solarinnovations.com

Lock Options



Lock color choices: Metal, Clear Anodized, Black Painted, or White Painted. **Guard in Black or White.**